

PIANO INCLINABILE A SQUADRA

RIGHT ANGLE CHUTE

Il piano inclinabile a squadra, con ribaltamento da 0 a 90° sui due piani d'appoggio, è un apparecchio molto solido che consente grosse asportazioni di materiale.

Costruito interamente in ghisa legata con procedimento meehanite ad alta resistenza, stabilizzata, indeformabile, ben dimensionata e di minimo ingombro.

Le guide trapezoidali di scorrimento, complete su tutto l'arco d'appoggio del piano di lavoro ed i robustissimi bloccaggi, lo rendono compatto, privo di vibrazioni in ogni posizione di lavoro.

I nostri piani sono disponibili nei modelli:

- P1 e P2, rotazione manuale
- P1/RI e P2/RI, rotazione con chiave esagonale su pignone

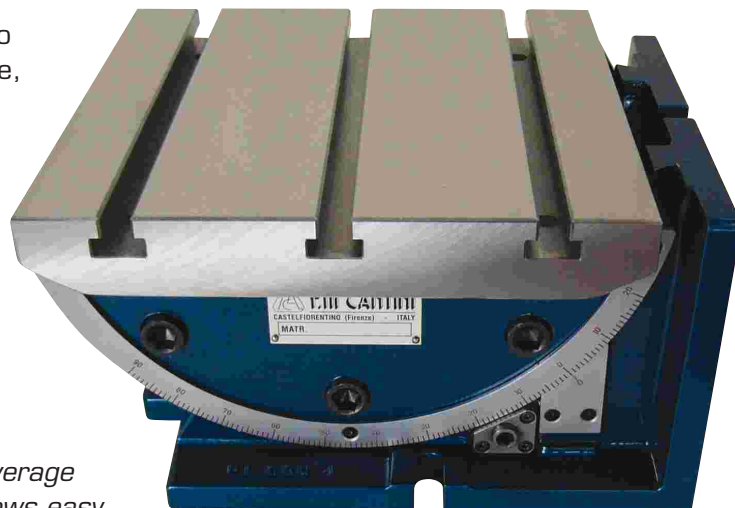

P2-RI

The right-angle chute, which comes with a 0 to 90° leverage range for its two faces, is a very sturdy device that allows easy removal of large quantities of material.

Made entirely of high-grade Meehanite cast iron, it is stabilized, in deformable, well proportioned and space saving. Its trapezoidal runners cover the complete circuit of its work surface support base, while its sturdy locks make it compact and vibration-free in all working position.

Our planes are available with the follow models:

- P1 and P2 manual rotation,
- P1/RI and P2/RI rotation with hexagonal key on pinion

The dimension of the grinded plan is the difference from P1 and P2, as shown in the follow table, P1 is 300x300, instead P2 is 300x450.

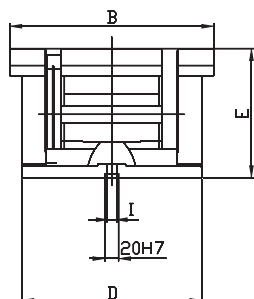
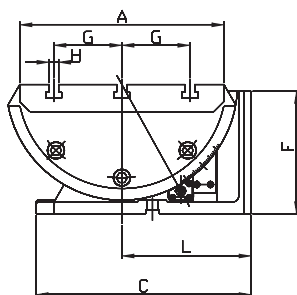
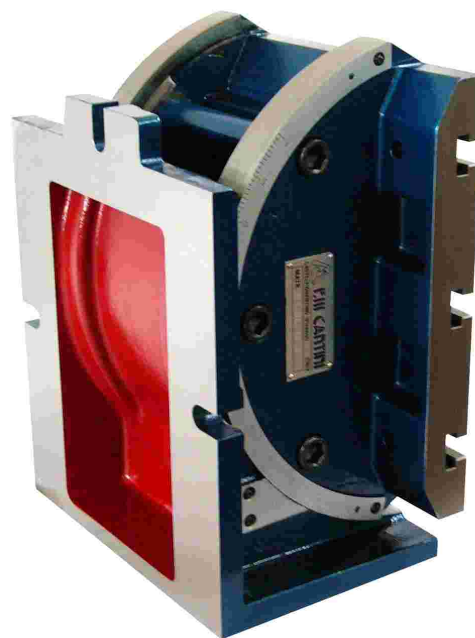
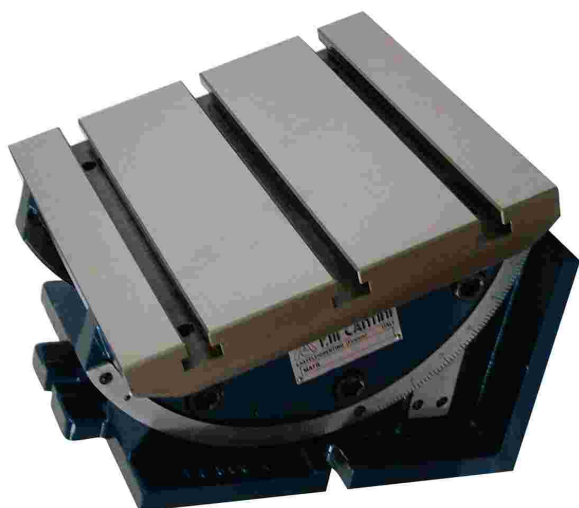

	A	B	C	D	E	F	G	H	I	L
P1/RI	300	300	316	270	190	180	100	14H7	16	190
P2/RI	300	450	316	270	190	180	100	14H7	16	190

*Su richiesta del cliente vengono prodotti piani inclinabili diversi dallo standard.
On customers request, we can produce tilting plane different from the standard.*